

P28系列 叶片缓冲式 Vane Damper

P28A0旋转阻尼器

单向扭矩输出 Uni-Directional 扭矩曲线输出 Torque curve output 固定式 Fixed 限制旋转角度 MAX. Rotation Angle <120°

§ 规格 Specifications



订货号CODE	型号Model	扭矩Rated torque	扭矩方向Direction	反向扭矩Reverse torque
283610303	P28A0-R303	30±4 kgf·cm	顺向CW(R)	5 kgf·cm
283610403	P28A0-R403	40±6 kgf·cm	顺向CW(R)	6 kgf·cm
283610503	P28A0-R503	50±8 kgf·cm	顺向CW(R)	7 kgf·cm
283610603	P28A0-R603	60±10 kgf·cm	顺向CW(R)	8 kgf·cm
283610703	P28A0-R703	70±12 kgf·cm	顺向CW(R)	9 kgf·cm

§ 性能描述 Performance Description

最大使用旋转角度为Max. rotation angle : 120°
 最大使用温度范围Operating temperature : -5 ~ 60°C
 产品外壳和端盖的材质Body & cap material: ZDC
 旋转轴材料Rotating shaft material: ZDC
 使用油Oil type : Silicone oil 硅油

注：1)标注扭矩为标准负载慢落每秒钟15°，温度23°C时测定的数据；
 2)翻转变安装定位面，使阻尼器输出逆时针方向缓冲扭矩；
 3)可以通过变更缓冲器油脂的粘度提供特殊扭矩定制。

Note:1)Rated torque measured at a speed of 15°/sec.at 23°when fall down;
 2)Change the installation location flip side to make the damper output buffer torque in Counter-clockwise direction;
 3)Torque can be customized by changing the oil viscosity.

§ 外形尺寸 Outside Diagram

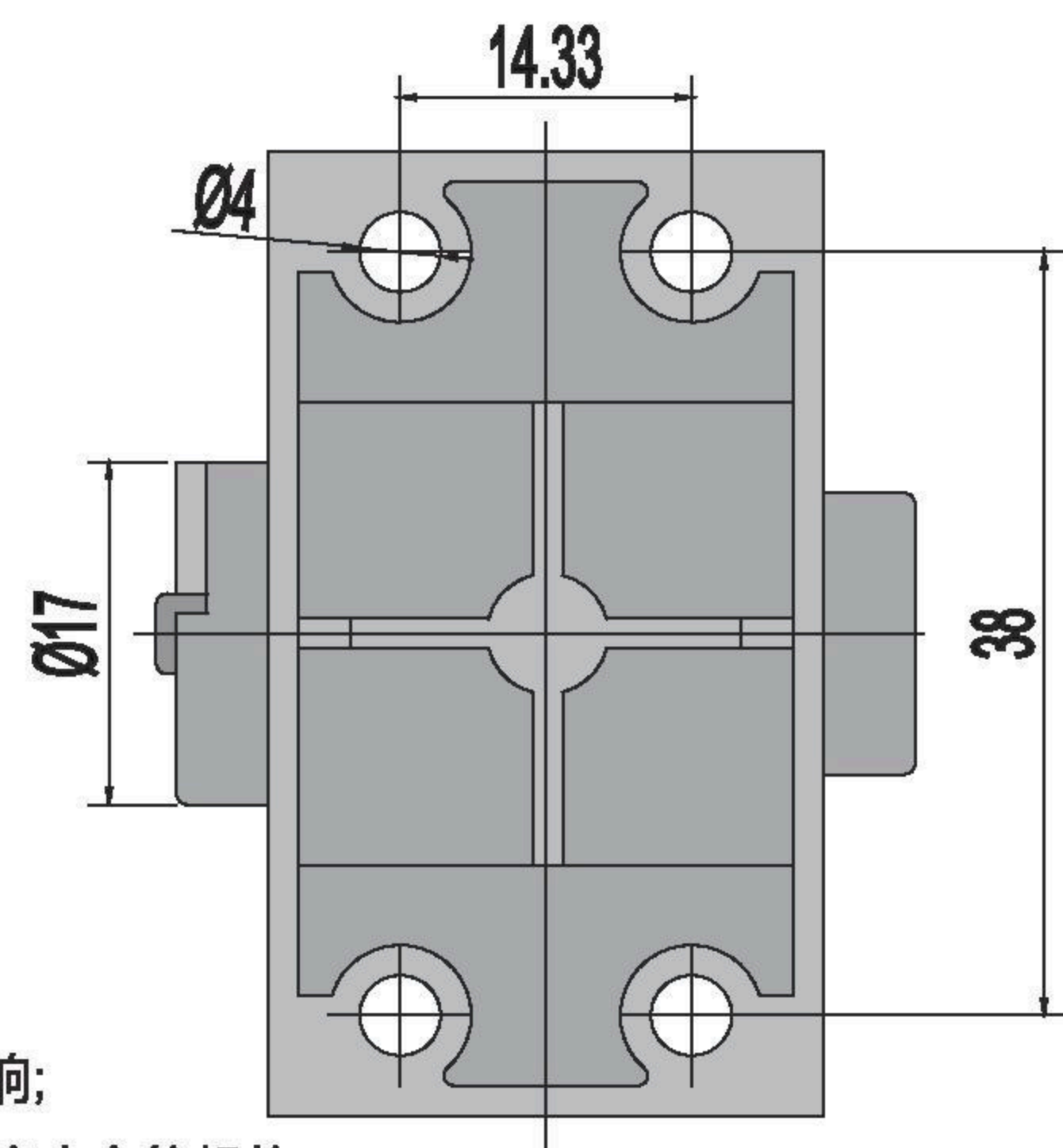
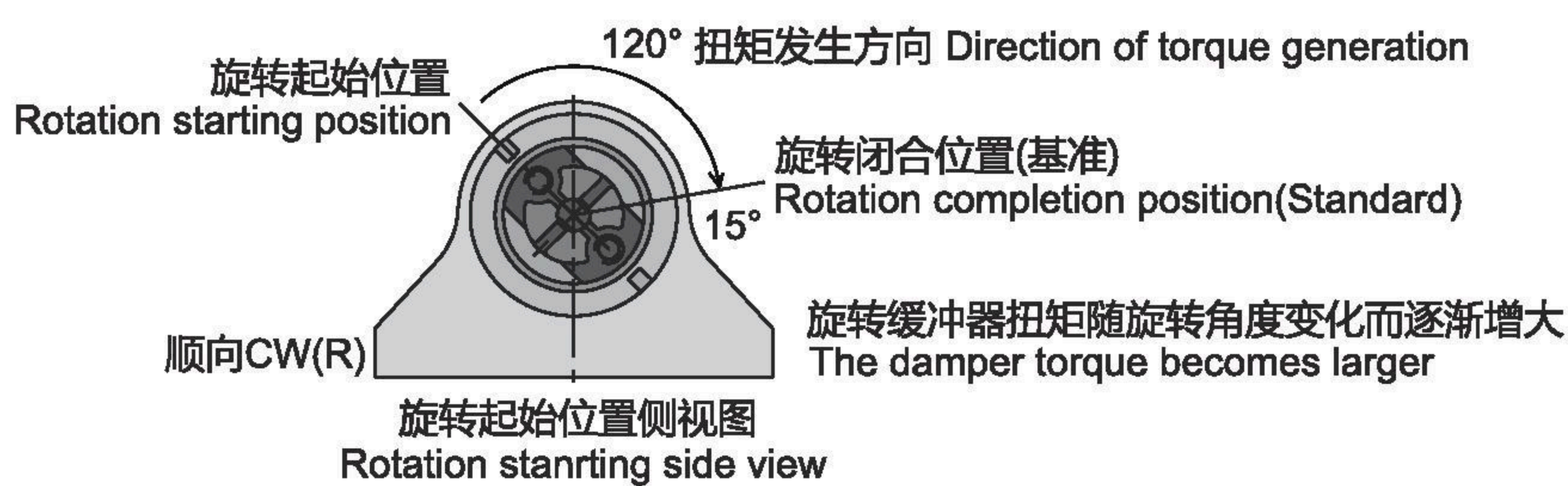
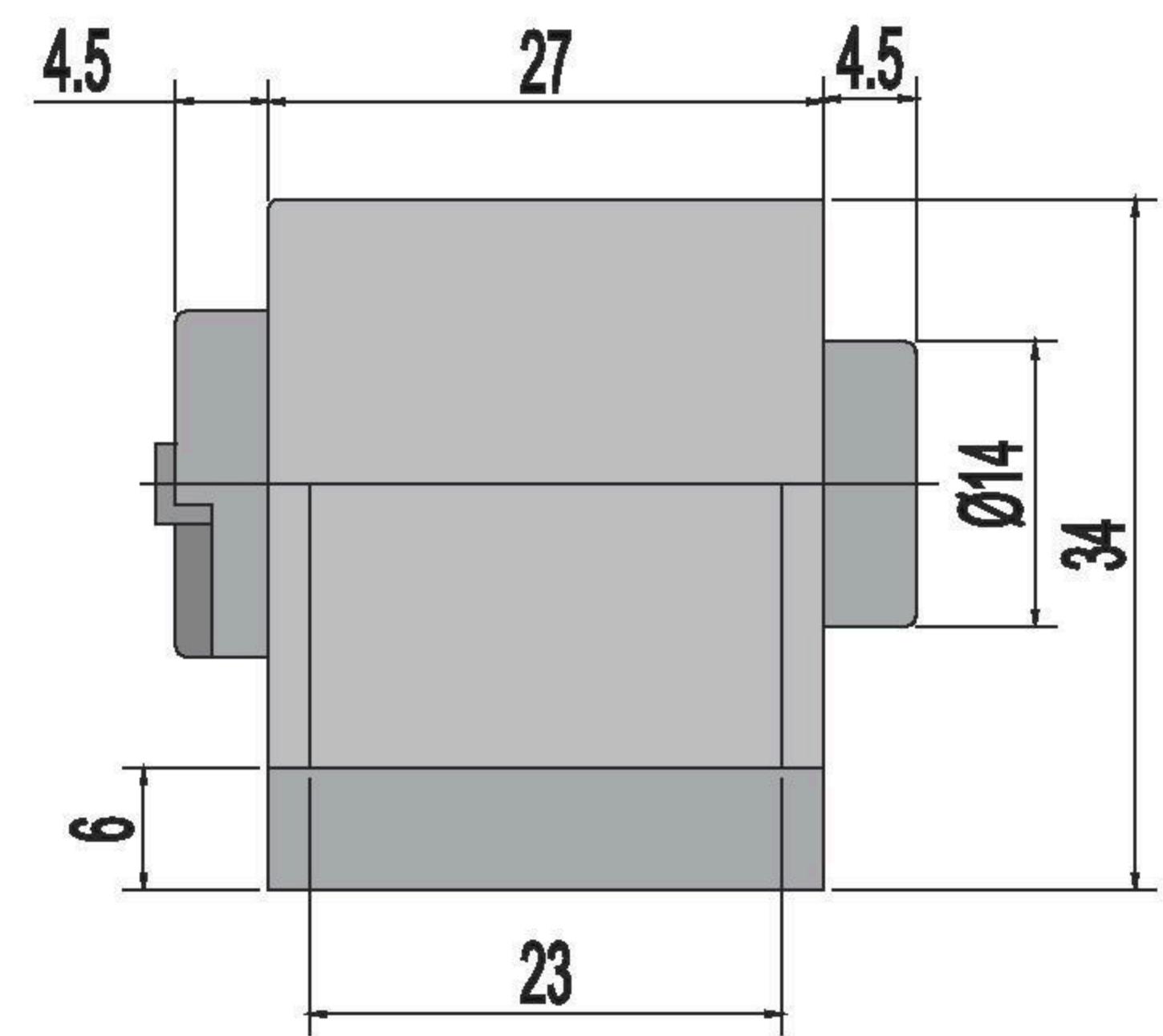
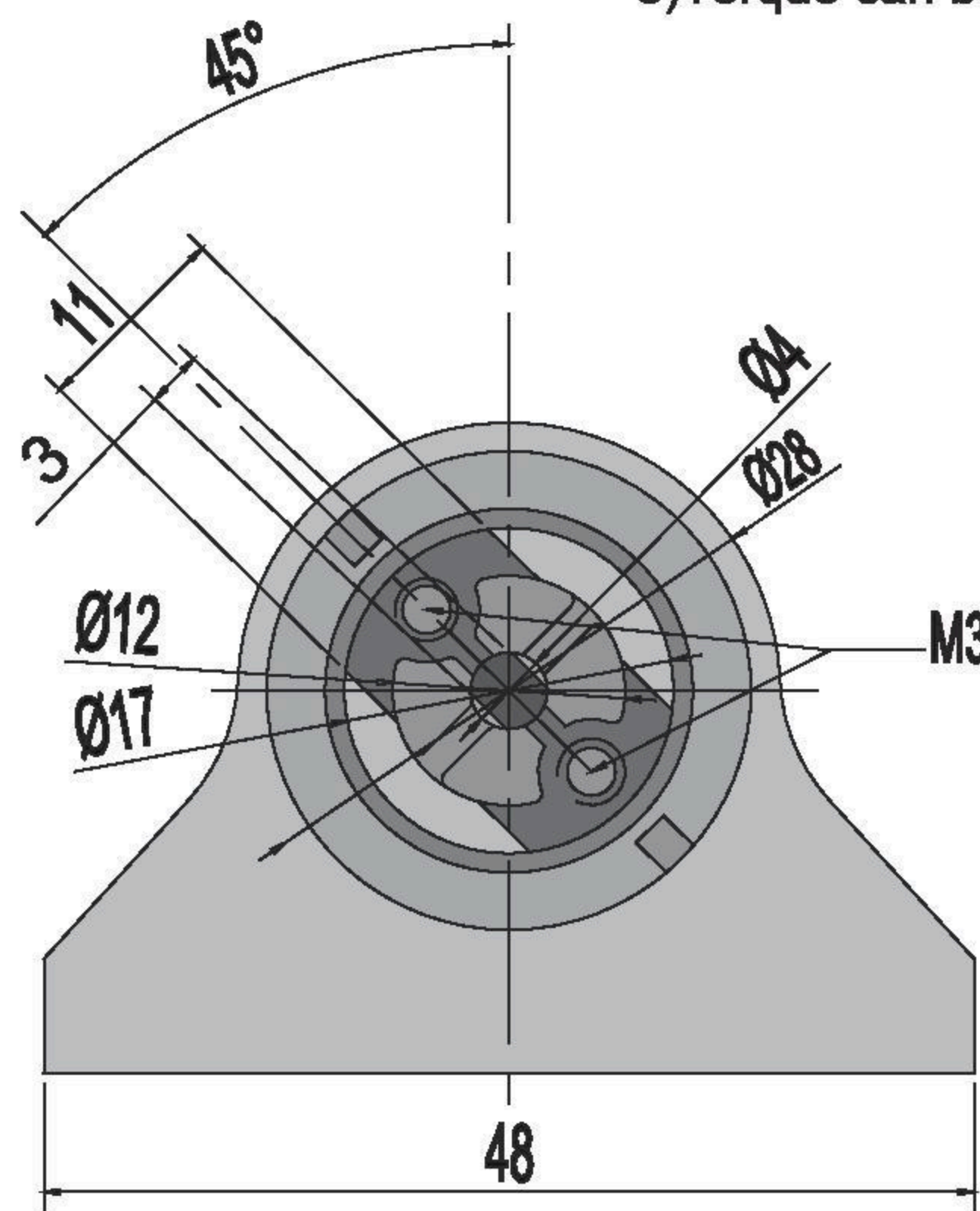

注：1)图示旋转闭合位置为缓冲终止位置，缓冲器在此角度时扭矩输出最大，并以此位置为缓冲终止安装基准，旋转轴扁位安装基准与底面安装面夹角为15°；
 2)旋转轴孔和配合部件的间隙请尽量减小，如果存在间隙，旋转缓冲的速度也会受到影响；
 3)缓冲器的旋转缓冲角度为120°，超过角度旋转时会损坏缓冲器本身，并请在外部设计停止定位机构。

Note:1)As pictures shown, the flat bit axis of rotation is the end position of buffering; the damper outputs the maximum torque at this position, and the buffering installation based on the flat bit axis of rotation. The installation of the axis of the flat a datum and the underside of the angle is 15°

2)When connecting the rotating shaft to other parts, please ensure a tight fit between them. Without a tight fit, the lid will not slow down properly when closing.

3)The damper's working angle is 120°, as pictures shown, rotating the damper beyond this angle will cause damage to the damper. Please ensure that an external stopper is in place.