

N20系列 叶片缓冲式 Vane Damper

单向扭矩输出 Uni-Directional 扭矩曲线输出 Torque curve output 固定式 Fixed 限制旋转角度 MAX. Rotation Angle <110°

N20A0(1)旋转缓冲器



N20B0旋转缓冲器



§ 规格 Specifications

订货号CODE	型号Model	扭矩Rated torque	扭矩方向Direction	反向扭矩Reverse torque
204510103	N20A0-R103	10±2 kgf·cm	顺向CW(R)	3 kgf·cm
204510153	N20A0-R153	15±3 kgf·cm	顺向CW(R)	4 kgf·cm
204510203	N20A0-R203	20±4 kgf·cm	顺向CW(R)	5 kgf·cm
204510253	N20A0-R253	25±5 kgf·cm	顺向CW(R)	6 kgf·cm
204510303	N20A0-R303	30±6 kgf·cm	顺向CW(R)	7 kgf·cm
204520103	N20A0-L103	10±2 kgf·cm	逆向CCW(L)	3 kgf·cm
204520153	N20A0-L153	15±3 kgf·cm	逆向CCW(L)	4 kgf·cm
204520203	N20A0-L203	20±4 kgf·cm	逆向CCW(L)	5 kgf·cm
204520253	N20A0-L253	25±5 kgf·cm	逆向CCW(L)	6 kgf·cm
204520303	N20A0-L303	30±6 kgf·cm	逆向CCW(L)	7 kgf·cm
205010103	N20A1-R103	10±2 kgf·cm	顺向CW(R)	3 kgf·cm
205010153	N20A1-R153	15±3 kgf·cm	顺向CW(R)	4 kgf·cm
205010203	N20A1-R203	20±4 kgf·cm	顺向CW(R)	5 kgf·cm
205010253	N20A1-R253	25±5 kgf·cm	顺向CW(R)	6 kgf·cm
205010303	N20A1-R303	30±6 kgf·cm	顺向CW(R)	7 kgf·cm
205020103	N20A1-L103	10±2 kgf·cm	逆向CCW(L)	3 kgf·cm
205020153	N20A1-L153	15±3 kgf·cm	逆向CCW(L)	4 kgf·cm
205020203	N20A1-L203	20±4 kgf·cm	逆向CCW(L)	5 kgf·cm
205020253	N20A1-L253	25±5 kgf·cm	逆向CCW(L)	6 kgf·cm
205020303	N20A1-L303	30±6 kgf·cm	逆向CCW(L)	7 kgf·cm
205011103	N20B0-R103	10±3 kgf·cm	顺向CW(R)	4 kgf·cm
205011153	N20B0-R153	15±4 kgf·cm	顺向CW(R)	5 kgf·cm
205011203	N20B0-R203	20±5 kgf·cm	顺向CW(R)	6 kgf·cm
205011253	N20B0-R253	25±6 kgf·cm	顺向CW(R)	7 kgf·cm
205021103	N20B0-L103	10±3 kgf·cm	逆向CCW(L)	4 kgf·cm
205021153	N20B0-L153	15±4 kgf·cm	逆向CCW(L)	5 kgf·cm
205021203	N20B0-L203	20±5 kgf·cm	逆向CCW(L)	6 kgf·cm
205021253	N20B0-L253	25±6 kgf·cm	逆向CCW(L)	7 kgf·cm

注：1)标注扭矩为标准负载慢落每秒钟15°，温度23℃时测定的数据；
2)可以通过变更缓冲器油脂的粘度提供特殊扭矩定制。

Note:1)Rated torque measured at a speed of 15°/sec.at 23°when fall down;
2)Torque can be customized by changing the oil viscosity.

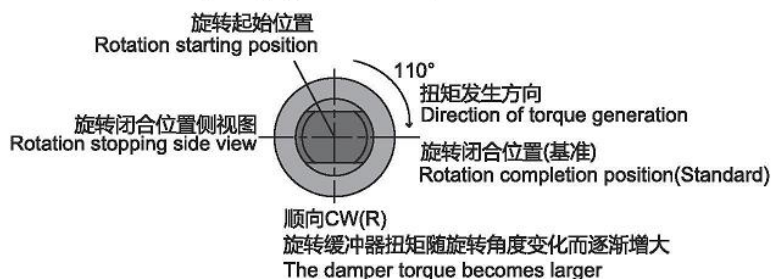

§ 性能描述 Performance Description

最大使用旋转角度为Max. rotation angle : 110°
最大使用温度范围Operating temperature : -5~60℃
产品外壳和端盖的材质Body & cap material: PBT
旋转轴材料Rotating shaft material: N20A0:PPS/N20A1(B0):PBT
使用油Oil type : Silicone oil 硅油

N20系列

叶片缓冲式
Vane Damper

单向扭矩输出
Uni-Directional

扭矩曲线输出
Torque curve output

固定式
Fixed

限制旋转角度
MAX. Rotation Angle <math><110^\circ</math>

§ 外形尺寸 Outside Diagram

N20A0 旋转缓冲器外形尺寸

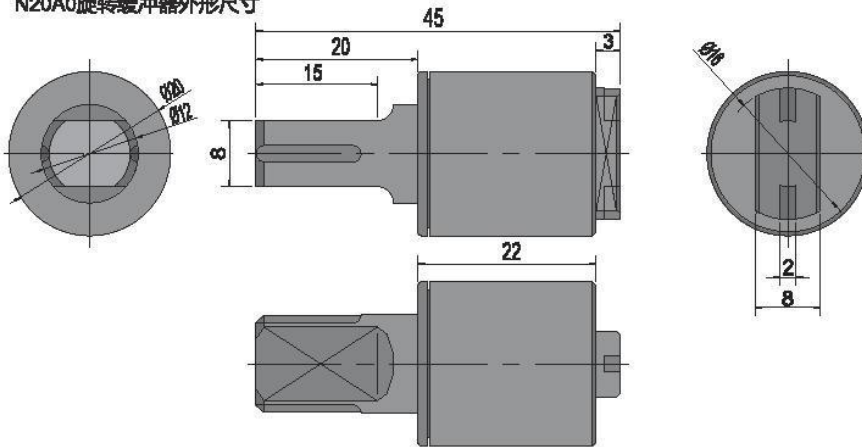

- 注: 1) 图示旋转闭合位置为缓冲终止位置, 缓冲器在此角度时 扭矩输出最大, 并以此位置为缓冲终止安装基准, 旋转轴扁位安装基准与本体另一侧定位扁位的夹角为 90° ;
- 2) 旋转轴孔和配合部件的间隙请尽量减小, 如果存在间隙, 旋转缓冲的速度也会受到影响;
- 3) 缓冲器的旋转缓冲角度为 110° , 超过角度旋转时会损坏缓冲器本身, 请在外部设计停止定位机构。

- Note: 1) As pictures shown, the flat bit axis of rotation is the end position of buffering; the damper outputs the maximum torque at this position, and the buffering installation based on the flat bit axis of rotation. The installation of the axds of the flat a datum and the other side of the flat a datum of the angle is 90° ;
- 2) When connecting the rotating shaft to other parts, please ensure a tight fit between then. Without a tight fit, the lid will not slow down properly when closing;
- 3) The damper's working angle is 110° , as pictures shown, rotating the damper beyond this angle will cause damage to the damper. Please ensure that an external stopper is in place.

N20A1 旋转缓冲器外形尺寸

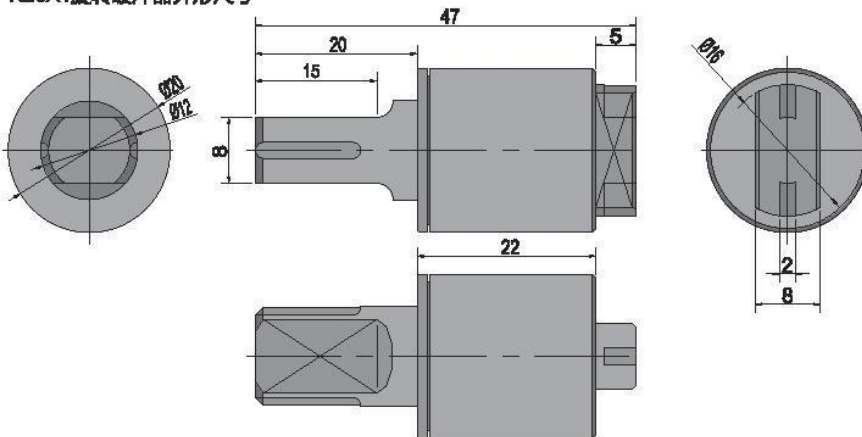

N20B0 旋转缓冲器外形尺寸

